

Design Features

- Dry pump cavity
- Self-priming operation
- Runs dry without damage
- Complete isolation of fluid pumped
- Heavy-duty roller bearings
- Variety of pump configurations, flows, and pressure ratings
- No dynamic seals, cups or packing to leak, wear or replace
- Reversible flow
- Low maintenance

Materials of Construction

Non-wetted Parts

Casing: Aluminum Alloy

Rotor: Aluminum Alloy

Rollers: Plastic/Alloy

Wetted Parts

Hose:

EXTRUDED – Neoprene, Varpren, Silicone

BRAIDED – EPDM, Hypalon, Nitrile Rubber, Natural Rubber (regular and heavy-duty)

Inlet/Outlet Connections:

PTFE or Stainless Steel Hose Barb, Stainless Steel or Carbon Steel ANSI Flange, PTFE NPT, and Stainless Steel Sanitary Tri-clamp

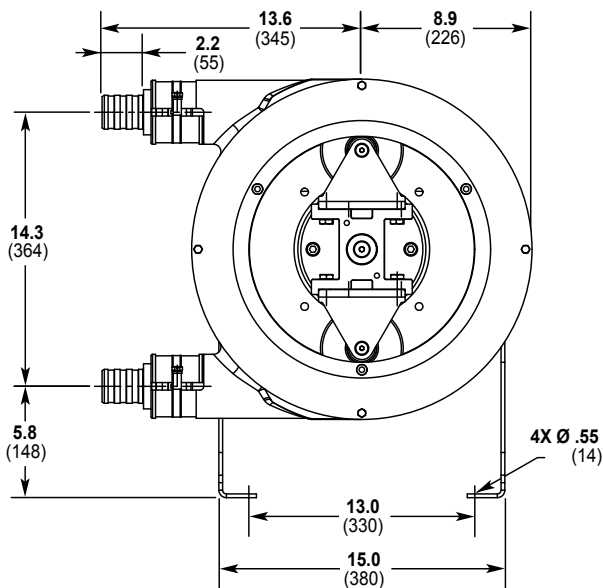

Dimensional Drawings

Inches (mm)

See Ordering Information for motor and gearbox sizes

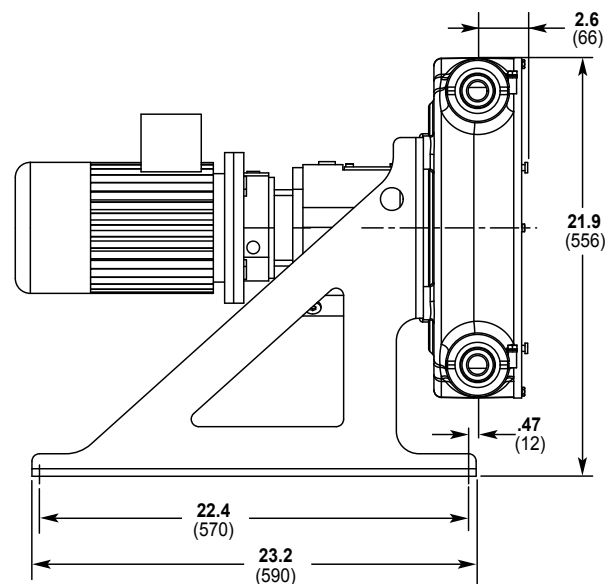

Performance

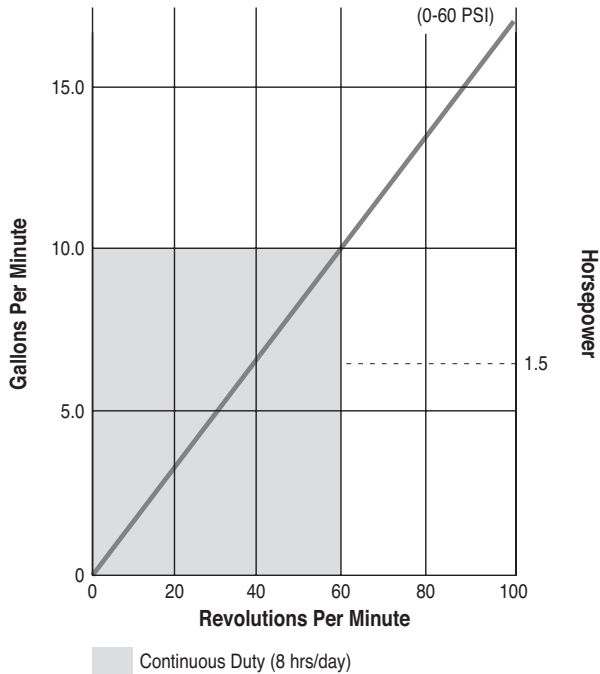

Fluid Characteristics

Viscosity:	15,000 cps max.
Liquid Temperature:	180°F (82°C) max.
Solid Size:	(see page 4)
Fiber Length:	1-7/8 inch (47.6 mm) max.

Specifications

Discharge Pressure:	60 psig (4.1 bar) max.
Suction Lift:	24 ft. (7.3 m)
Suction Pressure:	25 psig (1.7 bar) max.
Horsepower*:	2 max.
Hose Size:	30 x 55 x 1150 mm
Displacement:	0.182 gal/rev
Weight (pump only):	95 lbs. (43 kg)
Weight (with drive):	171 lbs. (78 kg)

* Pumps are shaft driven and require a gearbox and motor. See Ordering Information for details.

Model 2006 Ordering Information

A complete Vector pump order number uses a 9-character order code to identify the desired hose, fittings and drive. Select the appropriate items from the chart below and use the order code from each group to complete the pump assembly order number.

1	2	0	0	6	-	5	6	-	7	8	-	9	10
---	---	---	---	---	---	---	---	---	---	---	---	---	----

Order Digit	Order Code	Description		
1-4	2006	Pump Designation Model 2006 Shaft Drive Pump		
5-6		Hose Material/Type		
	EF	EPDM, fiber-braided		
	HF	Hypalon, fiber-braided		
	MF	Natural Rubber, fiber-braided, heavy-duty (200 psig max.)		
	NF	Natural Rubber, fiber-braided		
	PE	Neoprene, extruded (30 psig max.)		
	SE	Silicone, extruded (30 psig max.)		
	OF	Nitrile, Oil-rated, fiber-braided, heavy-duty (200 psig max.)		
	VE	Varpene, extruded (30 psig max.)		
7-8		Connector Material/Style		
	AA	PTFE, 1-1/4" hose barb		
	BB	316 SST, 1-1/4" ANSI flange		
	CC	316 SST, Sanitary, 1-1/2" tri-clamp		
	DD	Carbon Steel, 1-1/4" ANSI flange		
	EE	Carbon Steel, 1-1/2" male NPT		
	HH	PTFE, 1-1/4" male NPT		
	TT	SST 1-1/2" NPT		
	SS	316 SST, 1-1/4" hose barb		
9-10		Drive		
		Flow GPM		
		Gear Ratio		
		Pump RPM		
		Max Psig		
		3Ø, 1 BHP TEFC, 230-460 VAC, 60 Hz		
		4:1 Constant Torque Speed Range		
B2	3.5	90:1	19	45(60) ¹
		3Ø, 1-1/2 BHP TEFC, 230-460 VAC, 60 Hz		
		4:1 Constant Torque Speed Range		
D2	4.8	65:1	27	45(60) ¹
F2	7.2	43:1	40	45(60) ¹
		3Ø, 2 BHP TEFC, 230-460 VAC, 60 Hz		
		4:1 Constant Torque Speed Range		
H2	10.3	30:1	57	35(45) ¹
J2	14.1	22:1	78	35(45) ¹
A				No Drive

¹() Heavy-duty, fiber-braided hose